

# **ARCHITECTURAL SPECIFICATIONS**

## **CIG JAN PRODUCTS LTD VISUAL DISPLAY BOARDS**

### **Part 1-General**

#### **1.01 RELATED DOCUMENT**

- A.** The provision of the General Conditions. Supplementary Conditions and the Sections included under Division 1. General Requirements are included as part of this Section though bound herein.

#### **1.02 SUMMARY**

- A.** The work of this Section includes Markerboards, tackboards, trim, adhesive, installation devices and accessories.
- B.** Related Work Specified Elsewhere
  - 1.** Markerboards and tackboards that are specified with and as a component of equipment in other Sections shall be furnished with the Section in which it is specified.
  - 2.** Required wood or metal supports within metal stud wall system coordinated with Section 09250-Gypsum Board.
- C.** Refer to Section 00100 for Alternative, that might affect the Work of this Section

#### **1.03 SUBMITTALS**

- A.** Complete shop drawings for proposed boards and panels units showing components, arrangements, dimensions, orientation on walls, section of trim members, and dimensioned elevations, grounds, reinforcements, and accessories.
- B.** Complete materials list of all items proposed to be furnished and installed.
- C.** Complete suitable color selection materials (sample chart, card, etc.) for proposed markerboard surfaces and proposed vinyl fabrics and corks.
- D.** Specific project certification from manufacturer assuring full compliance with 25 flame spread rating (per ASTM E84) for proposed mounted tackboard assemblies

#### **1.04 QUALITY ASSURANCE**

- A.** Qualifications
  - 1.** Manufacturer: Use products in the work of this Section produced by manufacturers regularly engaged in manufacture of similar items and with a history of successful production acceptable to the Architect/Engineer.
  - 2.** Installers: Use skilled workmen who are thoroughly trained and experienced in the necessary crafts and who are completely familiar with the specified requirements and the methods needed for proper performance of the work of this section.
- B.** Regulatory Requirements & References: Comply with standards specified in this Section.

#### **1.05 WARRANTY**

- A.** Manufacturer shall warrant visual display boards to be free from defects in material and workmanship for a period of 1 year

- B. Manufacturer shall guarantee that porcelain enamel face sheets on chalkboards and markerboards will retain original writing and erasing qualities for the life of the building.

Part 2-Products

2.01 MANUFACTURERS

- A. Required items shall be products of Cig Jan Products Inc., Grand Rapids, MI., specified as the type, size, function, and quality of equipment required.
1. Series "C" markerboards and tackboards
- B. Products of the following manufacturers will be considered, providing equipment equals or exceeds the quality specified and they can provide equipment of the type, size, function and arrangement required.
1. Cig Jan Products, Grand Rapids, Michigan
  2. PolyVision Alliance Steel, Okmulgee, Oklahoma

2.02 MARKERBOARDS AND TACKBOARDS

- A. Types: Factory built fixed units. Height of markerboards and tackboards shall be 4 feet, unless otherwise indicated. Provide individual and combination markerboards and tackboards units as indicated.
1. Markerboard Construction (MB)
    - a. Markerboard face sheet shall be PolyVision Wall 28 gauge liquid writing surface
    - b. Core material and other requirements and accessories are as follows:
      - 3/8 inch thick minimum Industrial Grade particle board
      - aluminum foil backing
      - Porcelain face sheet, class titanium frit
      - M.O.H. porcelain hardness: 6.5
      - Provide map rail for each unit
      - Provide chalk trough for each unit
      - Markerboard color shall be as selected by Architect from standard colors.
      - Provide a butt joint at adjacent chalkboard and adjacent marker board face sheets, and secure with concealed splice plates
  2. Tackboard Construction (TB)
    - a. Factory built, fixed units, vinyl covered tackboards with the following characteristics:
      - Type 1, Class 1 rated vinyl
      - Provide "Koroseal" Type II vinyl fabric surface
      - 1/2 inch thick minimum Industrial Grade Fiberboard core material
    - b. The color of the boards shall be selected by Architect from a full available range of colors
    - c. Provide single one piece units wherever possible. Where lengths indicated exceed manufacturer's standard maximum length, provide a grouping of complete individual factory-built units of sizes to equal the total length indicated, composed of the minimum number of units, number, length, and locations of units shall be as approved by the Architect.

**2.03 TRIMS AND ACCESSORIES**

A. Trim: Shall be extruded aluminum, anodized on exposed surfaces, with clear satin finish. Provide 2 inch angle hangers for units. Top rail of chalkboards and markerboards to be standard one inch map rail with natural cork insert

1. Provide the following accessories for each individual

Chalk board and markerboard unit:

- a. 4 map hooks (metal)
- b. 2 map rail ends
- c. 1 flag holder (one per room)

**2.04 WALL ATTACHMENT**

A. Chalkboard, markerboard, and tackboard fasteners as follows:

1. CMU: Butterfly bolts into block core
2. Drywall: Metal screws into metal stud system

**Part 3**

**3.01 INSPECTION**

- Examine the areas and conditions under which work of this Section will be performed. Correct conditions detrimental to the proper and timely completion of the work to approval of the Architect/Engineer. Do not proceed until unsatisfactory conditions have been corrected.

**3.02 DELIVERY**

- A. Deliver factory-built chalk/tack boards as units completely assembled in one piece, without joints, whenever possible. When overall dimensions require delivery in separate units, pre-fit at factory, disassemble for delivery, and make final joint at site.
- B. Delivery dates to be finalized & confirmed with contractor responsible for the project. When boards are scheduled and delivered to the defined location and rejected at the site; an additional delivery cost will be billed to the responsible party.

**3.03 INSTALLATION**

- Install boards in locations and at mounting heights as shown on the Drawings, and in accordance with the manufacturer's instructions. Provide all grounds, brackets, anchors, trim, and accessories for a complete installation.

**3.04 FINAL INSPECTION**

- The manufacturer's recommended installation procedures, when approved by the Architect. Engineer, will become the basis for inspecting and accepting or rejecting actual installation procedures used on the work.

# TRIM OPTIONS AND INSTALLATION DETAILS

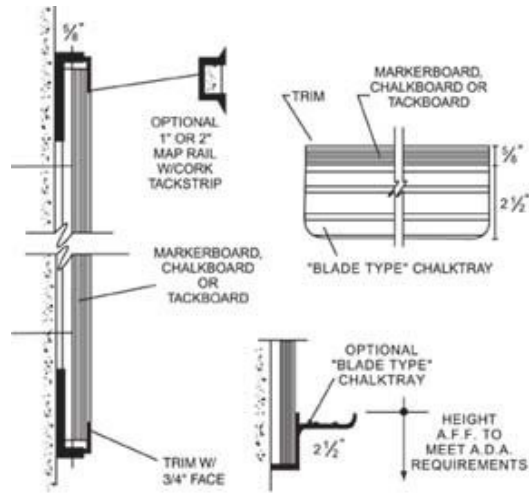

**J Trim**

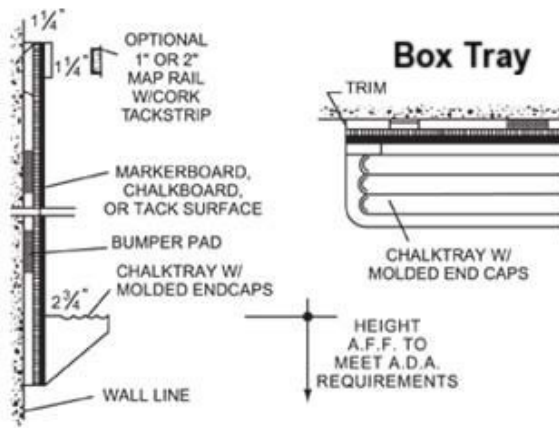

**Deluxe Trim**

**BOARD LAYOUTS**

